

## Y-Ball Check Valves

- Sizes 1 1/2" thru 3"
- All metal product contact surface are 316L stainless steel
- Polished ID and OD to 3A standard
- PTFE ball provides a better heat and abrasion resistance
- Repair kits are available for seat replacement
- Easy cleaning without tools
- Two piece design for better alignment
- Air blow check valve can be added
- Maximum operating pressure:150 PSI
- Operating temperature range:15°F to 200°F



## Specifications

Valve Size	Weight (lbs.)	Cap Size	Clamp Size	Cap Gasket	Ball Diameter	Cracking Pressure Inches(H <sub>2</sub> O)		Seating Pressure(PSI)		Flow Coefficient (C <sub>v</sub> )
						Vertical	Horizontal	Vertical	Horizontal	
1 1/2"	4.9	2.0	2.0	2.0	1.6	2.0	0.5	3.6	3.9	60
2"	6.6	2.5	2.5	2.5	2.1	2.5	0.5	2.6	3.7	80
2 1/2"	10.5	3.0	3.0	3.0	2.7	3.0	0.5	1.6	2.4	100
3"	17.5	4.0	4.0	4.0	3.6	3.8	0.5	1.9	2.6	140

## Dimensions

Size	A	B	C	D	E	F
1 1/2"	7.500" (19.50mm)	1.370" (34.80mm)	1.500" (38.10mm)	3.300" (83.82mm)	1.900" (48.26mm)	2.500" (63.50mm)
2"	8.500" (215.90mm)	1.870" (47.50mm)	2.000" (50.80mm)	3.900" (99.06mm)	2.300" (58.42mm)	3.000" (76.20mm)
2 1/2"	10.000" (254.00mm)	2.370" (60.20mm)	2.500" (63.50mm)	4.500" (114.30mm)	2.900" (73.66mm)	3.600" (91.44mm)
3"	11.500" (292.10mm)	2.870" (72.90mm)	3.000" (76.20mm)	5.300" (134.62mm)	3.800" (96.52mm)	4.700" (119.38mm)

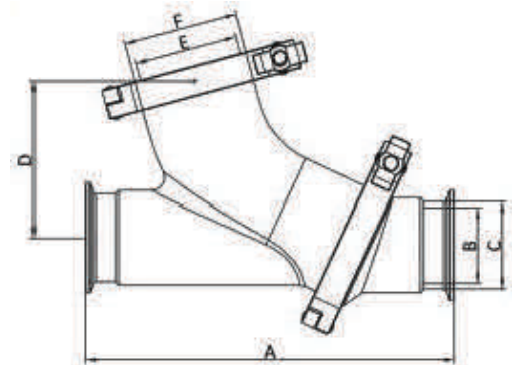

## Y-Ball Check Valves

### Material List



Item	Description	Material	Quantity
1	angle body	316L	1
2	inlet body	316L	1
3	clamp	CF8	2
4	end cap	316L	1
5	cap gasket	EPDM	1
6	ball	PTFE	1
7	seat	EPDM/CF3M	1